

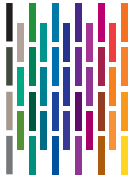

Fibre Bonded
Carpet & Tiles



Entrance Area
Carpet & Tiles



Care Range
Tufted Carpet

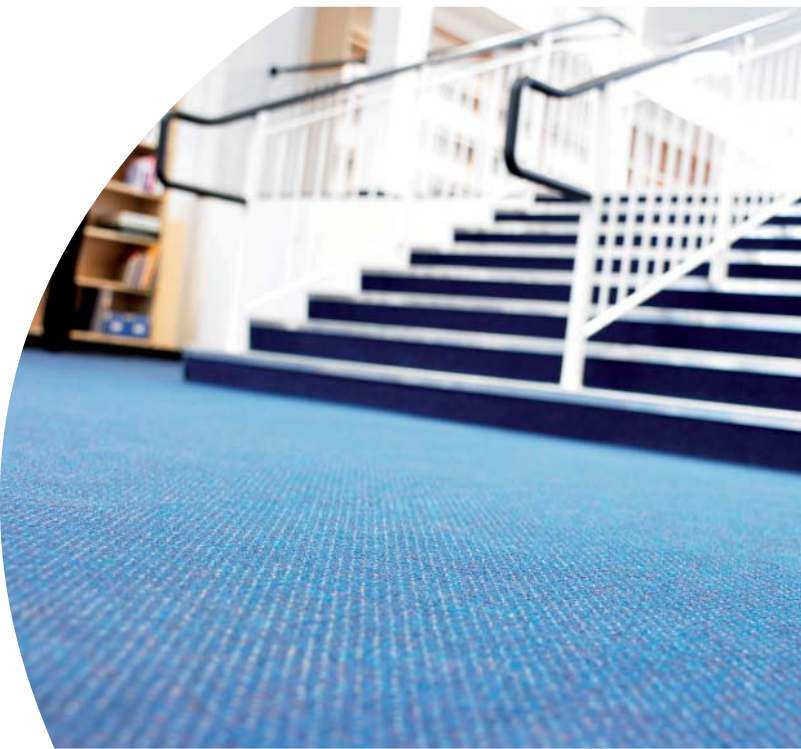

Floor Preparation

All aspects of subfloor preparation and floorcovering installation should be in accordance with BS 5325 (The Installation of Textile Floorcoverings), and installation guides as published by the Contract Flooring Association. During the laying period a temperature of at least 18°C must be maintained and a floor temperature of at least 10°C. The type and condition of the subfloor has a direct influence on the installation and performance of a floorcovering and the importance of subfloor preparation cannot be emphasised too strongly.

For full information see the F. Ball Subfloor Preparation Guide which gives comprehensive advice on subfloor preparation.

Concrete and Sand/Cement Screed

These must be fully cured, sound, smooth, dry and free from laitance, dust, plaster and any other contaminants which prevent good adhesion.

Direct to earth subfloors must incorporate an effective damp proof membrane. Materials and methods for damp-proofing solid floors are described in BS 8102 and in Department of Environment Leaflet 47 from www.defra.gov.uk

New concrete and sand/cement screeds must be left for construction moisture to dry out before floorcoverings are laid. For estimated drying times see BS 5325. Floorcoverings should not be laid until a hygrometer test in accordance with BS 5325 Annex A, Dampness Testing, gives a relative humidity reading of not more than 75%.

Damp floors may be treated with **STOPGAP F75** or **STOPGAP F76** waterproof surface membranes as appropriate.

Uneven surfaces must be smoothed using **STOPGAP** smoothing underlayments to prepare the surface for adhesive and floorcovering.

Very absorbent surfaces should be primed with dilute **STOPGAP P131** before the application of adhesive or smoothing underlayment.

Concrete Treatments/Coatings

Waterproofing admixtures may adversely affect adhesion and should not be used.

Chemical hardening/curing treatments should not be used on concrete bases as there could be an interaction with the smoothing underlayment or adhesive used. If these chemical treatments have been used they should be mechanically removed e.g. by scabbling or shotblasting the surface before applying smoothing underlayment or adhesive.

Concrete floor paints must be completely removed by mechanical methods such as scabbling or shotblasting before application of a smoothing underlayment or adhesive.

Epoxy and polyurethane surface coatings should preferably be removed, but if this is not possible and provided they are firmly bonded, some coatings may be primed with neat **STOPGAP P131** prior to skimming with the appropriate **STOPGAP** smoothing underlayment. Coatings vary considerably in this respect and we would suggest you check adhesion by prior testing to ensure a satisfactory bond is achieved.

Non-Absorbent Surfaces

Ceramic and quarry tiles, granolithic, terrazzo and power floated concrete slabs which have been trowelled to produce a dense smooth surface tend to be non-absorbent in nature. If the recommended **STYCCOBOND** adhesive is not suitable for direct application to a non-absorbent surface, then the subfloor must be skimmed with a minimum of 3mm of the appropriate **STOPGAP** underlayment. Heavily glazed surfaces should be treated to create a key for the smoothing underlayment e.g. by scabbling or scouring with a coarse abrasive.

N.B. Ceramic and quarry tiled surfaces should be skimmed with the appropriate **STOPGAP** underlayment to prevent the tile pattern transferring through to the surface of the floorcovering.

Terrazzo and quarry tiles are unaffected by dampness but may be sufficiently permeable to allow the passage of water vapour and are often laid in areas which do not incorporate a damp proof membrane. Where this is the case, these bases should be damp proofed by covering with a layer of flooring grade mastic asphalt complying with BS 6925.

Asphalt and STOPGAP surface waterproof membranes must be skimmed with a minimum of 3mm of the appropriate smoothing underlayment.

Priming

Most subfloors will require priming.

Use neat **STOPGAP P131** neoprene primer on smooth impervious subfloors prior to the application of the appropriate **STOPGAP** floor smoothing underlayment.

Very absorbent surfaces should be primed with dilute **STOPGAP P131** or **STOPGAP P121** before the application of adhesive or smoothing underlayment.

Existing Floorcoverings

Thermoplastic, vinyl asbestos or similar floor tiles, flexible vinyl and rubber sheet and tiles, linoleum and textile floorcoverings must be removed, together with the bulk of the adhesive and the subfloor made good before installing the new floorcovering.

Adhesive remaining on cementitious subfloors should be removed by mechanical methods such as scraping, scabbling or shotblasting at least until a thin, smooth, firmly bonded residue remains. All adhesive that is loose, lumpy, powdering, soft or water soluble must be removed. A minimum of 3mm of the appropriate **STOPGAP** underlayment should be applied before the installation of the new floorcovering.

Adhesive remaining on wooden floors should be overpinned with flooring grade plywood or hardboard (see Wooden Floors). Any existing underlays should first be removed.

Wooden Floors

Wooden Floors must be structurally sound, level, smooth, dry and clean. Adequate ventilation should be provided to suspended timber floors at ground level to ensure that the moisture content of the wood is maintained at equilibrium. Worn or uneven floorboards should either be replaced or levelled by sanding, planing or by patch filling with **STOPGAP 114/Green Bag** latex underlayment before finally covering with flooring grade plywood. Sheets should be positioned, joints staggered and nailed at 100mm - 150mm centres. (See BS 8203 for details).

Wood blocks are not suitable for direct application of sheet and tile flooring because of the continuous differential movement of the blocks and the risk of the wood block design transferring through the floorcovering surface. Provided the wood blocks are smooth, sound, level and securely bonded, they should be overlaid with flooring grade plywood. Any uneven areas should first be patch filled with **STOPGAP 114/Green Bag** latex smoothing underlayment. Wood blocks laid on the ground floors must have an effective damp proof membrane incorporated in the subfloor. If there is any doubt that all these conditions can be met then the wood blocks must be removed, and the subfloor made good.

Wood mosaic panels require overpinning with flooring grade plywood or hardboard in all cases. This is not practical on solid floors and panels should therefore be removed and the subfloor made good as above. If panels laid over a flexing timber floor need patch filling, **STOPGAP 114/Green Bag** latex underlayment should be used. In all other respects wood mosaic panels should be treated as for wood blocks.

Chipboard, should comply with BS5669 flooring grades type C2, C4 or C5.

It is essential that **floating chipboard** and other **composition floors** are dry, as a gully may develop between the skirting board and the edge of the floorcovering as the boards shrink on drying.

Chipboard, plywood and hardboard must be primed with **STOPGAP 131** diluted as recommended.

Raised Access Modular Floors

These are designed to give ready access to underfloor services. All module units must be structurally sound, level, smooth and free from contaminants.

Backed carpet tiles are suitable for this type of base, broadloom carpets are not suitable.

Composition Floors

Composition floors such as those constructed of magnesium oxychloride (magnesite) cement or polyvinyl acetate/cement will be adversely affected by dampness rising from the ground if they are covered with an impervious layer. Unless it can be established that the composition floor is adequately protected against rising dampness, it must be removed and the base made good before floorcoverings are installed. If the floor is protected against dampness then cracks and small hollows should be patch filled and the whole area skimmed with a minimum of 3mm of the appropriate **STOPGAP** underlayment.

Anhydrite Screeds

Anhydrite screeds should be sound, smooth and dry. Any surface laitance must be removed and all dust vacuumed off. It is essential that the surface is primed with dilute **STOPGAP P121** liquid prior to the application of a **STOPGAP** floor smoothing underlayment or **STYCCOBOND** adhesive.

Planning and Securing Carpet Tiles

STYCCOBOND F41 is applied over the complete floor to provide a permanently tacky film which prevents "loose lay" carpet tiles from moving under normal traffic.

Very heavy high density traffic such as experienced with heavy trolleys and with concentrated stiletto heel or caster chair traffic around desks, filing cabinets, photocopiers etc. can cause considerable damage to some carpet tiles. It is not possible to overcome such problems by the use of adhesive but experience has shown that permanently bonding the tiles in such areas will help to extend their life.

Planning and Positioning Tiles

The carpet tiles should be allowed to acclimatise for at least 24 hours before installation, at the temperature and humidity conditions likely to be encountered during normal service.

Heckmondwike FB tiles should be laid rotationally, alternating the direction of the tile through 90°. Directional arrows can be found on the reverse of each tile.

Lay out tiles along one wall to leave at least half a tile border along both walls. Measure the distance AB to give the border plus a number of whole tiles. Measure and mark out CD on the opposite wall to the same distance as AB. Strike a chalk line between D and B. This should now be parallel to the long wall.

Lay out tiles along DB or measure to find out point E near the centre of DB which leaves a border of at least half a tile along each side wall.

Using a T square or by measuring a 3:4:5 triangle as on the diagram mark out the line FEG so that it is exactly at right angles to DB.

Apply the **STYCCOBOND F41** to the whole floor area and allow to fully dry.

Place tiles accurately edged to the line commencing at the point E. Continue placing tiles along each successive row ensuring that the first tile is exactly edged on line EF.

Complete this section of the floor. When placing the tiles apply firm pressure with the palm of the hand and run the thumb around the edges ensuring complete contact with the adhesive and the exclusion of all air. Cover the remaining sections in the same manner.

Fixing The Perimeter Tiles

Position the tile to be cut, in its correct design direction and place it exactly over the last tile in its row. Position another tile butted against the wall and over the tile to be cut. Mark where the back edge of the top tile crosses the tile. Remove the tiles and cut cleanly through the perimeter tile with a sharp knife. The section furthest away from the wall should now slide forward and fit exactly into the border.

To fit around door posts, architraves etc., the same method can be used. Alternatively an accurate template can be made of stiff cardboard and the shape transferred to the tile for cutting. With the template in position on the floor, apply several pieces of double sided adhesive tape to its top surface. Place the perimeter tile in position and lower it on to the double sided tape to accurately locate the template on the underside of the tile. This can then be removed and cut into the shape of the template.

When the floor has been completed, roll in both directions with a 68kg flooring roller, or use a spatula as directed by the floorcovering manufacturer.

Installation Plan

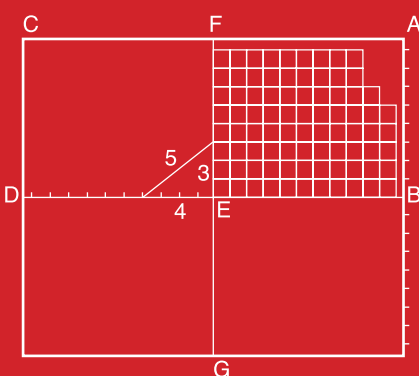

Tile Directions

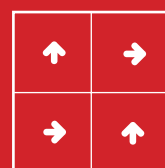

Planning and Securing Care Range Tufted Carpets (Impervious Backed)

The method described below is provided for guidance only, we cannot accept responsibility for workmanship and problems arising from improper installation. In all cases the floorcovering should be rolled out flat in a minimum room temperature of 18°C for 24 hours to allow acclimatisation.

1. Wherever possible lay the floorcovering down the length of the room to minimise the number of joints. Avoid joints in doorways and high traffic areas.
2. Measure the length of the room and cut the carpet to suitable lengths allowing sufficient for trimming. Ensure allowance is made for doorways, alcoves and any irregularities in the walls.
3. Position the first length, the perimeter edge lapping up the wall.



4. Trim the carpet down the opposite selvedge using the carpet cutter or trimming knife to leave a clean straight edge

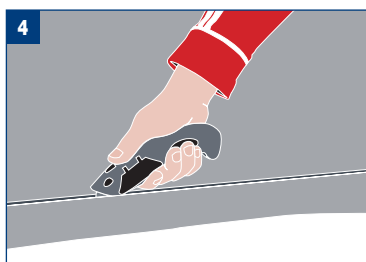

5. Position the second length of carpet, with the edge of the first length overlapping the second by approximately 50mm.

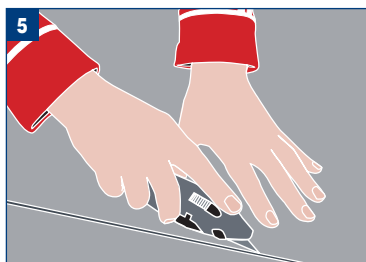

6. Using the trimmed edge of the first length as a guide, cut the edge and remove the surplus.



7. Prepare a compression seam joint by overlapping the edge of the first piece with the second piece by approximately 3mm.

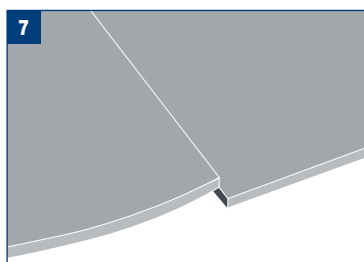

8. Fold back both edges by half the width of the carpet taking care not to disturb the positioning of the carpet. Apply the recommended adhesive to the subfloor, then re-position the first piece of carpet and roll with a 68kg flooring roller to ensure overall contact with the adhesive.



9. Squeeze F30 seaming adhesive on the primary and woven secondary backing along the edge of the first piece, to prevent fibre loss.

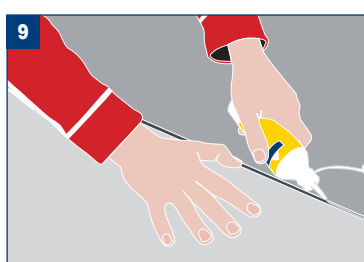

10. Immediately relay the second piece starting at the centre, press the edge into the seaming adhesive along the entire length. Any fullness of carpet should be dissipated away from the seam.



11. Successive lengths of carpet should be installed as previously described. Fold back the width of the first and last lengths adjacent to the perimeter and apply the adhesive to the subfloor as described, reposition the carpet and roll.

12. Using a sharp knife or Araseur trim the carpet to fit against the perimeter walls.

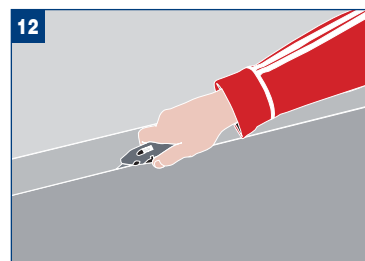

13. When the floor has been completely covered re-roll the area again to maintain adhesive contact.



Planning and Securing Fibre Bonded Carpets

The method described below is provided for guidance only, we cannot accept responsibility for workmanship and problems arising from improper installation. The method follows the stages for bonding the carpet before making the seams and trimming the edges. In all cases the floorcovering should be rolled out flat in a minimum room temperature of 18°C for 24 hours to allow acclimatisation.

1. Wherever possible lay the carpet down the length of the room to minimise the number of joints. Avoid joints in doorways and high density traffic areas. Measure the length of the room, and cut the first piece from the roll allowing an additional 75mm for trimming. Ensure an allowance is made for doorways, alcoves and any irregularities of the walls. Starting at the corner furthest from the door, lay the first piece into position lapping up the walls at both ends for sufficient trimming.

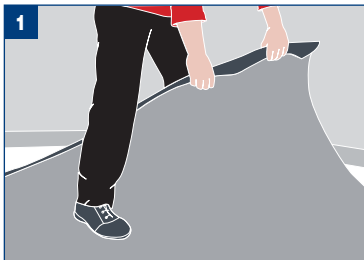

2. Run a pencil along the inner edge of the flooring making a guide line on the floor for the application of adhesive.

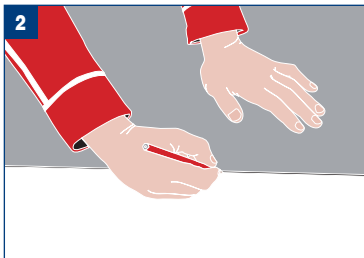

3. Fold the sheet half way back taking care not to disturb the positioning of the flooring. Apply the recommended adhesive onto the subfloor, from the wall to within 20cm of the guide line. Replace the carpet carefully and accurately back into position and roll with a 68kg flooring roller to ensure overall contact with the adhesive. Repeat for the other half of the sheet.



4. Measure and cut the second piece from the roll. Position the second piece with the edge overlapping the first by approximately 5cm and mark a guide line on the floor with a pencil at the next seaming edge.

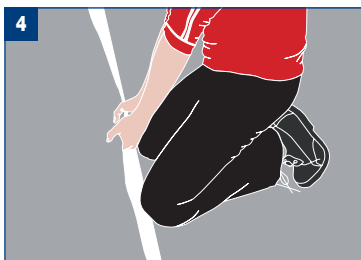

5. Fold the sheet half way back taking care not to disturb the positioning of the flooring. Apply the recommended adhesive onto the subfloor using the application techniques previously described, from 20cm inside the first guide line to 20cm inside the next. Replace the carpet carefully and accurately back into position and roll with a 68kg flooring roller to ensure overall contact with the adhesive. Repeat for the other end of the sheet. Successive lengths may be installed in this way.



6. Using an Araseur or a sharp knife trim the carpet to fit against the perimeter walls.

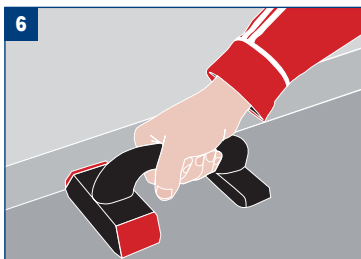

7. Position a straight edge along the middle of the overlap and cut through both pieces of carpet with a sharp knife and remove the surplus. Fold back the seam edges and apply adhesive onto the subfloor with the STYCCOBOND notched spreader. Re-lay the carpet and roll with a 68kg flooring roller to ensure overall contact with the adhesive.

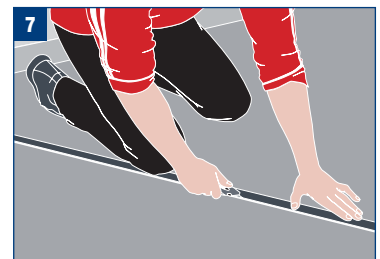

8. When the floor has been completely covered re-roll the area again to maintain good adhesive contact.



Fibre Bonded
Carpet & Tiles

Adhesive Technical Information

STYCCOBOND F2 - Release Sealer

TYPE - A solvent free, synthetic polymer emulsion which is designed to provide a release coating when used with the recommended adhesive. When suitable floorcoverings are installed on this coating they may subsequently be removed without leaving large quantities of backing and adhesive on the subfloor. Installations will withstand normal wet cleaning techniques and are suitable for use over normal underfloor heating installations.

TOOLS - STYCCOBOND Paint Roller or medium stiff brush.

APPLICATION - Apply evenly over the whole area and leave to dry before applying adhesive. Where a priming coat has been used, it must be allowed to dry before the sealer coat is applied.

COVERAGE - Approximately 6m² per litre.

STYCCOBOND F3 - Flooring Adhesive

TYPE - A rubber/resin adhesive designed to give good wet grab and early build-up of strength with some retained tack. It is non-flammable, protected against bio-degradation, will withstand normal wet cleaning techniques and is suitable for use over normal underfloor heating installations.

It may be used on sound, smooth, dry subfloors of concrete; granolithic; sand/cement screeds; **STOPGAP** and other floor smoothing underlayments; terrazzo; flooring grade chipboard, plywood and hardboard; wood; thermoplastic and quarry tiles. Asphalt and **STOPGAP** surface waterproof membranes must be skimmed with a minimum of 3mm of the appropriate **STOPGAP** smoothing underlayment.

TOOLS - STYCCOBOND 2mm x 6mm or 3mm x 6mm 'V' notched trowel. F Ball **GLYDA** trimming knife, 68kg flooring roller.

APPLICATION - Holding the trowel at an angle of 60°, spread the adhesive evenly over the subfloor and allow to dry partially to a paste-like consistency before laying the floorcovering. Care should be taken, particularly on absorbent surfaces, to ensure that the adhesive does not dry past its open time and still gives good transfer to the back of the floorcovering. Following the manufacturer's laying instructions place the floorcovering and press from the centre outwards to exclude air and ensure overall contact with the adhesive. Apply pressure by rolling with a 68kg flooring roller from end to end and side to side (on foam backed floorcoverings use the **GLYDA**) to ensure good transfer to the back of the carpet. It may be necessary to re-roll the carpet 30 minutes later to ensure overall adhesion is maintained.

COVERAGE - Approximately 3m² per litre, depending on the condition and absorbency of the subfloor. The coverage will be reduced when using the 3mm x 6mm trowel.

STYCCOBOND F41 - Surface Tackifier

TYPE - An acrylic polymer emulsion adhesive, designed to provide a permanently tacky film which prevents 'loose lay' carpet tiles from moving under normal traffic but enables them to be lifted and replaced easily when required. It is non-flammable, is protected against bio-degradation, is resistant to plasticiser migration and will withstand normal wet cleaning techniques. It may be used on sound, smooth, dry subfloors of concrete; sand/cement screeds; **STOPGAP** and other suitable floor smoothing underlayments; flooring grade of chipboard, plywood and hardboard; wood; steel; thermoplastic and quarry tiles; linoleum and vinyl floorings. Asphalt must be skimmed with a minimum of 3mm of the appropriate **STOPGAP** smoothing underlayment.

TOOLS - Styccobond paint roller or medium-stiff brush or short nap roller.

APPLICATION Apply the adhesive to the floor surface evenly over the whole area with brush or roller. Allow to dry to a clear tacky film before placing the tiles into position on the floor, press firmly over the entire area paying particular attention to the edges.

CAUTION: When using **STYCCOBOND F41** over a raised access floor system, pour the tackifier into a tray and apply carefully using a **STYCCOBOND** paint roller to avoid adhesive penetration between the panels. Under no circumstances should the tackifier be poured directly onto the floor. The tackifier must be allowed to dry completely before the tiles are laid.

COVERAGE - Approximately 7m² per litre, depending on the condition and absorbency of the subfloor.

STYCCOBOND F52 - Gum/Spirit Adhesive

TYPE - A polymer reinforced gum/spirit adhesive designed to provide a rigid setting bond. It will withstand normal wet cleaning techniques and is suitable for use over normal underfloor heating installations. It may be used on sound smooth dry subfloors of concrete; granolithic; sand/cement screeds; **STOPGAP** and other floor smoothing underlayments; terrazzo; flooring grade chipboard; plywood and hardboard; wood; thermoplastic and quarry tiles and steel. Asphalt, **STOPGAP** surface waterproof membranes and non absorbent surfaces such as terrazzo and some power floated concrete slabs should be skimmed with a minimum of 3mm of the appropriate **STOPGAP** smoothing underlayment.

STYCCOBOND F52 contains highly flammable solvents and must be stored, transported and used strictly in accordance with current legislation.

TOOLS - 2mm x 6mm 'V' notched trowel. 68kg flooring roller.

APPLICATION - Holding the trowel at an angle of 60°, spread the adhesive evenly over the subfloor that can be covered whilst the adhesive remains receptive and gives good transfer. Immediately lay the floorcovering into the adhesive and roll from end to end and side to side to ensure good transfer to the back of the floorcovering. 1-4 hours later roll again in two directions.

STYCCOBOND F60 - Contact Adhesive

TYPE - A synthetic rubber/resin solution contact adhesive which is designed to provide a strong instant bond on vertical surfaces, stair treads and risers but may also be used on some floor surfaces. It may be used on sound, smooth, dry subfloors of concrete; granolithic; sand/cement screeds; **STOPGAP** and other floor smoothing underlayments; terrazzo; flooring grade chipboard; plywood and hardboard; wood; thermoplastic and quarry tiles and steel. Asphalt and **STOPGAP** surface waterproof membranes should be skimmed with a minimum of 3mm of the appropriate **STOPGAP** smoothing underlayment.

STYCCOBOND F60 contains highly flammable solvents and must be stored, transported and used strictly in accordance with legislation.

TOOLS - STYCCOBOND safety spreader or flat brush.

APPLICATION - Use the spreader, held at an angle of 60°, or brush, to apply a thin coat of the adhesive evenly to the back of the covering and to the floor or wall surface. Allow the solvent to evaporate until the adhesive becomes touch dry before bringing the two coated surfaces together. Apply pressure from the centre outwards to avoid trapping air, ensure that good contact is made over the whole area.

COVERAGE - Approximately 2m² per litre, coating both surfaces.

STYCCOBOND F66 - Solvent Free Contact Adhesive

TYPE - A solvent free contact adhesive providing a safer alternative to conventional solvent based adhesives. May be applied by brush/roller or notched spreader. Suitable for use over normal underfloor heating.

It may be used on sound, smooth, clean surfaces of concrete; sand/cement screed; granolithic; terrazzo; **STOPGAP** or other floor smoothing underlayments, plaster, plasterboard, flooring grade hardboard, plywood and steel. Asphalt and **STOPGAP** waterproof surface membranes should be skimmed with a minimum of 3mm of the appropriate **STOPGAP** smoothing underlayment.

TOOLS - 'V' notched spreader 1.4mm x 2.5mm

APPLICATION - Holding the spreader at an angle of 60° apply the adhesive to both surfaces. Allow the adhesive to become touch dry before bringing the two surfaces together within the next seven hours. If the drying time exceeds seven hours then warm air heat reactivation may be used, taking care that there is no contamination of the adhesive film. Apply pressure from the centre outwards to avoid trapping air.

COVERAGE - Approximately 5m² per litre per coat depending on the subfloor and floorcovering.

STYCCOBOND F74 - Polyurethane Adhesive

TYPE - A one pack moisture curing polyurethane adhesive suitable both for fixing floorcoverings and for seaming synthetic grass carpets. It is water resistant and is suitable for use outdoors although it is not intended to be a damp proof membrane. It is resistant to oil and grease and is suitable for use over normal underfloor heating systems. It may be used on sound, smooth, clean surfaces of concrete; sand/cement screed; granolithic; **STOPGAP** and other floor smoothing underlayments. Asphalt and **STOPGAP** surface waterproof membranes should be skimmed with a minimum of 3mm of the appropriate **STOPGAP** smoothing underlayment.

TOOLS - **STYCCOBOND** 2mm x 6mm 'V' notched trowel. 68kg flooring roller.

APPLICATION - Holding the trowel at an angle of 60°, spread the adhesive evenly over an area of the subfloor that can be covered within the open time of the adhesive. Following the manufacturers laying instructions place the floorcovering immediately into the adhesive whilst it is still wet, pressing from the centre outwards to exclude air, then roll with a 68kg flooring roller to ensure complete contact.

Curled flooring will need to be weighted in contact with the adhesive until it has cured.

Non-absorbent subfloors must be skimmed with a minimum 3mm application of the appropriate smoothing underlayment to assist the adhesive curing process.

COVERAGE - Approximately 1.5m² per kg, depending on the condition and absorbency of the surface.

STYCCOBOND F81 - Epoxy Adhesive

TYPE - A solvent free, two part epoxy adhesive designed for the installation of floorcoverings in areas that may be subject to large amounts of surface water. When cured, it is resistant to water, oil and grease. Although it is suitable for outdoor use, it is not intended to be a damp proof membrane.

It may be used on sound, smooth, clean surfaces of concrete; granolithic; sand/cement screed; **STOPGAP** smoothing underlayment and other floor smoothing underlayments; terrazzo and steel. Asphalt and **STOPGAP** waterproof surface membranes must be skimmed with a minimum of 3mm of the appropriate **STOPGAP** smoothing underlayment.

TOOLS **STYCCOBOND** 2mm x 6mm 'V' notched trowel. 68kg flooring roller.

APPLICATION Holding the trowel at an angle of 60°, spread the adhesive evenly over the subfloor that can be covered within the open time of the adhesive. Following the manufacturers laying instructions place the floorcovering immediately into the adhesive whilst it is still wet, pressing from the centre outwards to exclude air, then roll with a 68kg flooring roller to ensure complete contact.

Curled flooring will need to be weighted in contact with the adhesive until it has cured.

COVERAGE Approximately 1.5m² per kg, depending on the condition and absorbency of the surface.

Health and Safety Advice

Detailed Health and Safety information for F. Ball and Co Ltd's adhesives and associated products is provided on Manufacturer's Material Safety Data Sheets, available through wholesalers and distributors.

To confirm this publication is up to date please call Technical Services Tel: 01538 361633.

NB - Information on the IQ Spray System and spray adhesives S910 and S920 can be obtained by contacting F. Ball and Co. Ltd Technical Service Department.



Fibre Bonded
Carpet & Tiles



Entrance Area
Carpet & Tiles



Care Range
Tufted Carpet

| | Backing | Permanent | Release | Heavy Duty/Wet | Vertical | Seaming |
|---------------------------|---------------|-------------|---------|----------------|---------------|---------|
| Fibre Bonded Sheet | | | | | | |
| Supacord | Fibre Bonded | F3.F52.S910 | F2/F3 | - | F60.F60NF.F66 | - |
| Montage | Fibre Bonded | F3.F52.S910 | F2/F3 | - | F60.F60NF.F66 | - |
| Broadrib | Fibre Bonded | F3.F52.S910 | F2/F3 | - | F60.F60NF.F66 | - |
| Iron Duke | Fibre Bonded | F3.F52.S910 | F2/F3 | - | F60.F60NF.F66 | - |
| Hobnail | Fibre Bonded | F3.F52.S910 | F2/F3 | - | F60.F60NF.F66 | - |
| Wellington Velour | Fibre Bonded | F3.F52.S910 | F2/F3 | - | F60.F60NF.F66 | - |
| Battleship | Fibre Bonded | F3.F52.S910 | F2/F3 | F74.F81 | F60.F60NF.F66 | - |
| Conqueror | Fibre Bonded | F3.F52.S910 | F2/F3 | F74.F81 | F60.F60NF.F66 | - |
| Zephyr | Fibre Bonded | F3.F52.S910 | F2/F3 | | | |
| Hippo | Rubber Waffle | F3* | F2/F3 | F74.F81 | F60.F60NF.F66 | - |
| Kiddies Corner | Rubber Waffle | F3* | F2/F3 | - | F60.F60NF.F66 | - |
| Dreadnought | Rubber Waffle | F3* | F2/F3 | F74.F81 | F60.F60NF.F66 | - |
| Vanquisher | Rubber Waffle | F3* | F2/F3 | F74.F81 | F60.F60NF.F66 | - |
| Super Dreadnought | Rubber Crumb | F3.S910 | - | F74.F81 | F60.F60NF.F66 | - |
| Gympro | Rubber Crumb | F3.S910 | - | F74.F81 | F60.F60NF.F66 | - |
| Diamond | Rubber Crumb | F3.S910 | - | F74.F81 | F60.F60NF.F66 | - |

Fibre Bonded Tile

| | | | | | | |
|-------------------|---------|----|----------|---|-----|---|
| Supacord | Bitumen | F3 | F41.S920 | - | F66 | - |
| Montage | Bitumen | F3 | F41.S920 | - | F66 | - |
| Broadrib | Bitumen | F3 | F41.S920 | - | F66 | - |
| Hobnail | Bitumen | F3 | F41.S920 | - | F66 | - |
| Wellington Velour | Bitumen | F3 | F41.S920 | - | F66 | - |
| Dreadnought | Bitumen | F3 | F41.S920 | - | F66 | - |
| Conqueror | Bitumen | F3 | F41.S920 | - | F66 | - |
| Super Dreadnought | Bitumen | F3 | F41.S920 | - | F66 | - |
| Diamond | Bitumen | F3 | F41.S920 | - | F66 | - |
| Precipice | Bitumen | F3 | F41.S920 | - | F66 | - |
| Zephyr | Bitumen | F3 | F41.S920 | - | F66 | - |
| Sticks & Stones | Bitumen | F3 | F41.S920 | - | F66 | - |

Tufted Sheet

| | | | | | | |
|---------------|-----------------|---------|---|---|---------------|-----|
| Dual-Care | Impervious Foam | F3.S910 | - | - | F60.F60NF.F66 | F30 |
| Platinum Care | Impervious Foam | F3.S910 | - | - | F60.F60NF.F66 | F30 |
| Total Care | Impervious Foam | F3.S910 | - | - | F60.F60NF.F66 | F30 |

*F3 applied using a 3mm X 6mm 'V' notched trowel

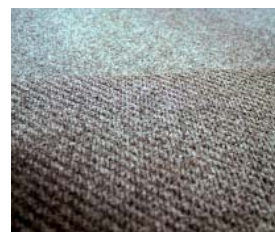
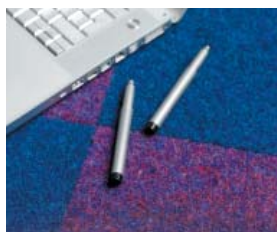

Standards

Quality Management System -
BS EN ISO 9001

Environmental Management System -
BS EN ISO 14001



F. Ball and Co. Ltd. Churnetside Business Park, Station Road,
Cheddleton, Leek, Staffordshire, ST13 7RS. UK.

Tel: +44 (0) 1538 361633 Fax: +44 (0) 1538 361622

Technical Services Fax: +44 (0) 1538 361567

Email: marketing@f-ball.co.uk
www.f-ball.co.uk



Heckmondwike F.B. A division of National Floorcoverings Ltd.
P.O. Box 7, Wellington Mills, Liversedge, West Yorkshire WF15 7FH.
Sales: +44 (0) 1924 406161 Admin: +44 (0) 1924 410544

Fax: +44 (0) 1924 413603

Email: sales@heckmondwike-fb.co.uk
www.heckmondwike-fb.co.uk